

Lock1WP

Pad Lock for Altronix Outdoor Enclosures

Altronix Lock1WP is a pad lock to secure the latches on Altronix Outdoor Enclosures for models such as WayPoint, NetWay, NetWay Spectrum, and Trove.



Lock1WP

Specifications

- Includes a single pad lock and key
(Recommended to use a pad lock for each latch)
- Body made of solid brass
- Inner components made of non-corrosive materials
- Shackle made from hardened steel
- Precision pin tumbler cylinder
- Self-locking: locking without key by pushing down the shackle
- Fits Altronix Outdoor Enclosures:
 - WP2, WP3, WP4, and WP5

Physical and Environmental

Dimensions:

1.5" x 2.36" x 0.52" (38.1mm x 60mm x 13.2mm)

Weight

Product Weight 0.35 lb. (0.16 kg)

Shipping Weight 0.4 lb. (0.19 kg)

Compatible Models:

Altronix Model	Dimensions
WP2	15.3"W x 17.53"H x 6.67"D (388.6 mm W x 445.3 mm H x 169.4 mm D)
WP3	11.31"W x 13.31"H x 5.59"D (287 mm W x 338 mm H x 142 mm D)
WP4	7.32"W x 9.5"H x 4.92"D (185.9 mm W x 236.7 mm H x 125 mm D)
WP5	17.32"W x 19.49"H x 9.58"D (439.9 mm W x 495 mm H x 243.3 mm D)

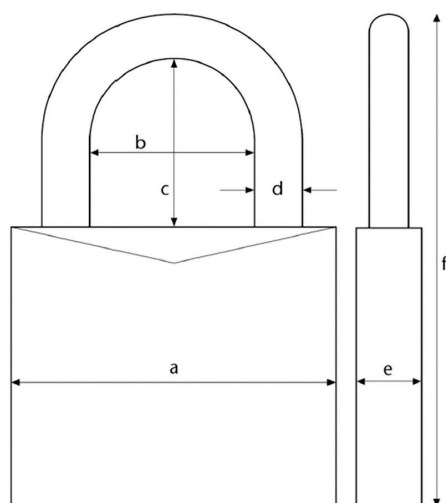

	Dimensions
a	Width – 1.5"
b	Horizontal Clearance – 53/64"
c	Vertical Clearance – 55/64"
d	Shackle Diameter – 1/4"
e	Depth – 33/64"
f	Height – 2 23/64"